

Godox

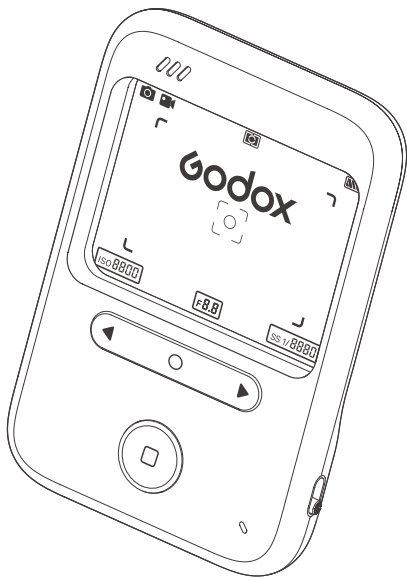

C100 使用手册

Instruction Manual V1.0

固件 Firmware V1.00

目录

重要安全说明	1
物品清单	2
部件名称	2
机身	2
透明取景屏	3
安装与准备	3
首次使用	3
模式切换	4
操作指南	4
常见问题	6
技术参数	7
维护保养	7

重要安全说明

使用前须仔细阅读本手册，并严格遵守以下安全注意事项。

危险

- 本设备内置锂电池，严禁拆卸、撞击、挤压或投入火中。若发现电池严重膨胀，立即停止使用。
- 若外壳出现开裂、变形、进液、异味或异常发热等情况，立即停止使用。
- 在插拔 TF 卡或进行数据传输时，请勿关机或断开连接，以免造成数据损坏或 TF 卡故障。
- 使用时，应放置在易散热的地方，不要放置在床头、被褥上、包裹里或其他不易散热的环境中使用，避免婴幼儿接触玩耍，儿童须在成人指导下使用。

警告

- 本设备不具备防水性能。严禁在雨天、浴室或高湿度环境中使用，避免液体流入内部造成短路或锈蚀。若设备从寒冷室外进入温暖室内产生冷凝水，等待干燥后再开机。
- 若设备进水或受潮，立即切断电源，并断开所有连接线缆。
- 严禁在酒精、汽油等易燃易爆气体或液体附近使用本设备。
- 严禁遮挡或堵塞设备散热孔，以防过热引发危险。
- 严禁私自拆卸或改装设备。非授权拆解易导致电路故障或永久性损坏。如需维修，联系神牛授权服务中心。

物品清单

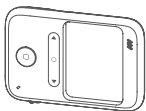

主机 ×1



USB-C 数据线 ×1

注：· 开箱后请仔细核对套装内物品。如有缺失或破损，请及时联系经销商。

· 图片仅供参考，请以实物为准。

部件名称

机身

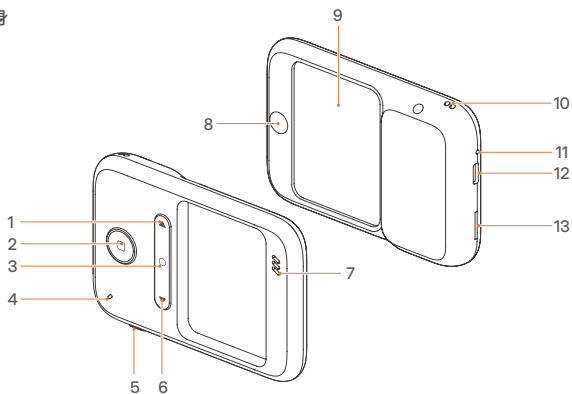

1. <◀> 调节键

2. 快门键

3. <○> 选择键

4. 指示灯

5. 模式拨钮

6. <▶> 调节键

7. 扬声器

8. 相机镜头

9. 透明取景屏

10. 挂绳孔

11. 复位孔

12. USB-C 接口

13. TF 卡槽

透明取景屏

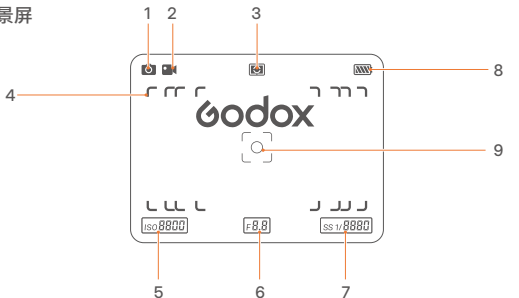

- | | | |
|---------|---------------------------|---------|
| 1. 拍照模式 | 4. 画幅框 (16:9、3:2、4:3、1:1) | 7. 快门参数 |
| 2. 录像模式 | 5. ISO 参数 | 8. 电量显示 |
| 3. 测光模式 | 6. 光圈参数 | 9. 对焦框 |

安装与准备

首次使用

检查电量

出厂时未充电，首次使用前须充满。

1. 使用标配充电线连接 USB-C 接口与电源适配器（另购），再接通电源。
2. 充电时，指示灯呈红色常亮；充满电后，指示灯熄灭。

安装 TF 内存卡

1. 本产品内置 TF 卡槽，最高支持 128 GB TF 卡扩展。
2. 按照图示方向插入 TF 卡，听到“咔哒”声表示安装到位。

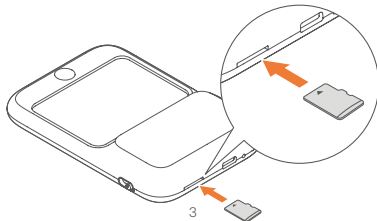

模式切换

拨动模式拨钮至对应档位切换四种模式：

模式	说明
🔌 开关机	<ul style="list-style-type: none">任意模式下无操作超过 5 分钟，设备自动关机关机后，将拨钮拨至开关机 <🔌> 位置，再重新推至目标模式即可开机
📷 拍照模式	顶部左侧显示相机图标，表示已切换至拍照模式
📹 录像模式	顶部左侧显示录像图标，表示已切换至录像模式
📏 测光模式	顶部中间显示测光图标，底部显示 ISO / 光圈 / 快门参数，表示已切换至测光模式

注：· 录像期间切换模式将自动停止拍摄并保存文件。

· 单个视频录制最大限制时间为 20 分钟，达到录制时间或 TF 卡内存存储满时自动结束录像并保存。

操作指南

拍照模式

1. 将拨钮推至拍照模式 <📷> 位置。

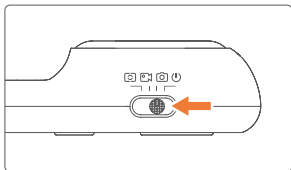

2. 按下 <◀> 或 <▶> 键切换画幅。

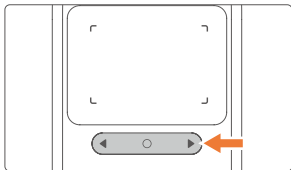

3. 按下快门键完成拍摄。

录像模式

1. 将拨钮推至录像模式 <📹> 位置。

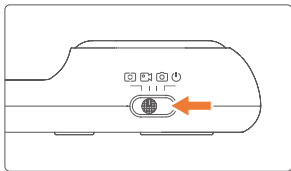

2. 按下 <◀> 或 <▶> 键切换画幅。

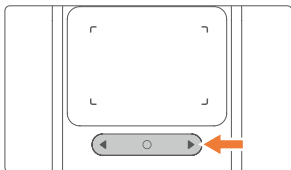

3. 按下快门键开始 / 结束录像。

画幅比例

拍照模式 <📷> 或录像模式 <📹> 下，通过 <◀> 或 <▶> 键切换四种画幅：

16:9	电影宽幅，适合风景及视频
3:2	标准胶片比例
4:3	经典相机比例
1:1	方形构图，适合社交媒体

测光模式

1. 将拨钮推至测光模式 <☉> 位置。

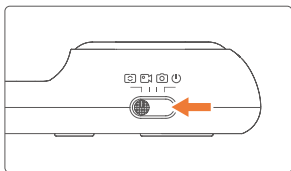

2. 对准需要测光的主体，设备测取透明取景屏中心约 25% 区域的曝光数据。
3. 按下 <O> 键选中调整项，闪烁进入可调状态；无上一次调整项则默认选中 ISO。
4. 按下 <◀> 或 <▶> 键切换当前项数值。按下快门键锁定并保存当前测光参数。
5. 测光参数范围：

参数	范围
ISO	100 - 800
光圈	f/1.0 - f/64
快门速度	1/8000 - 1s

注：· ISO 参数仅支持手动调节。

- 光圈与快门参数执行联动控制。手动调整其中任一参数时，设备自动实时计算并匹配另一参数，以保持当前的曝光总量（EV 值）恒定。
- 无操作 5 秒后，设备自动退出调整状态。

数据查看

通过 USB-C 数据线连接手机 / 电脑即可查看照片和视频。若指示灯持续闪烁，请检查 TF 卡是否插入或识别正常，确保格式为 FAT32 / exFAT（格式化前请备份数据）。

常见问题

问题	可能原因	解决方案
无法开机	<ul style="list-style-type: none"> · 电量耗尽 · 系统无响应 	<ul style="list-style-type: none"> · 使用 USB-C 数据线充电后重试 · 用卡针轻按复位孔重启
拍照、录像无反应	存储卡已满	删除不需要的文件或更换存储卡
屏幕显示异常	固件异常	联系官方支持
充电时指示灯不亮	数据线未连接好	检查数据线两端是否插紧

技术参数

产品名称	神牛透明取景相机
产品型号	C100
透明取景屏透光率	> 50%
存储方式	内置 TF 卡槽，支持最高 128 GB 扩展
充电 / 数据传输	USB-C
充电功率	5V=1A
电池续航	>1.5 小时（持续拍摄）
工作环境温度	5 - 40°C
屏幕尺寸	60.8 × 47.8mm
机身尺寸	104.1 × 71.7 × 19.1mm
净重（不含 TF 卡）	≈ 65g

规格和参数如有变更，恕不另行通知。

维护保养

- 清洁前务必关机并断开电源。仅可使用干燥软布擦拭，严禁使用酒精、苯或其他挥发性溶剂。
- 为延长电池寿命，长期闲置时须每 3 个月进行维护性充电，建议电量保持在 40% - 60%。

Contents

Important Safety Instructions	9
What's Inside	10
Names of Parts	10
Body	10
Transparent Viewfinder	11
Installation & Preparation	11
Preparing for First Use	11
Mode Switching	12
Operation Guide	13
Troubleshooting	15
Technical Data	16
Maintenance	16

Important Safety Instructions

Read this manual thoroughly before use and strictly observe the following safety precautions.

DANGER

- This device contains a built-in lithium battery. Do not disassemble, strike, crush, or expose it to fire. If the battery becomes severely swollen, stop using the device immediately.
- Stop using immediately if the housing is cracked or deformed, if liquid enters the device, or if it emits a strange odor or becomes abnormally hot.
- Do not force the device to power off or disconnect it while inserting, removing, or transferring data to/from the TF card, as this may cause data corruption or memory card failure.
- Place the device in a well-ventilated area during use. Do not cover the device or place it on beds, blankets, or inside bags where heat dissipation may be blocked. Keep out of reach of infants and children. Children should use this device under adult supervision.

WARNING

- This device is NOT waterproof. Do not use in rain, high humidity, or dusty environments.
- If liquid enters the device or it becomes damp, disconnect the power immediately and remove all cables.
- Do not use near flammable or explosive gases or liquids.
- Do not block or obstruct the air vents to prevent overheating.
- Do not disassemble or modify the device without authorization. Unauthorized disassembly may result in circuit malfunction or permanent damage. Contact an authorized Godox service center for repairs.

What's Inside

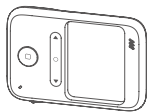

Main Unit x 1



USB-C Cable x 1

- Note:**
- Check the package contents after unboxing. If any items are missing or damaged, contact the dealer immediately.
 - Product images are for reference only. Actual product may vary.

Names of Parts

Body

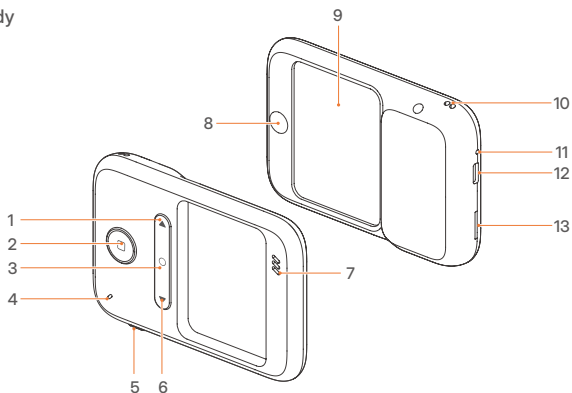

1. <◀> Adjust Button
2. Shutter Button
3. <○> Select Button
4. Indicator
5. Mode Switch

6. <▶> Adjust Button
7. Speaker
8. Camera Lens
9. Transparent Viewfinder

10. Lanyard Hole
11. Reset Hole
12. USB-C Port
13. TF Card Slot

Transparent Viewfinder

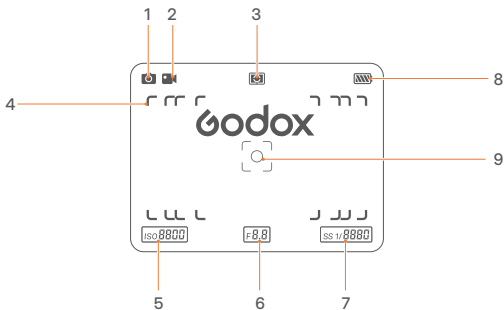

- | | | |
|------------------|--|-----------------------|
| 1. Photo Mode | 4. Aspect Ratio Frame
(16:9, 3:2, 4:3, 1:1) | 6. Aperture Data |
| 2. Video Mode | | 7. Shutter Speed Data |
| 3. Metering Mode | 5. ISO Data | 8. Battery Indicator |
| | | 9. Focus Frame |

Installation & Preparation

Preparing for First Use

Check Battery Level

The device is not fully charged from the factory. Fully charge before first use.

1. Connect the included power cable to the USB-C port and a power adapter (sold separately). Then plug the power adapter into a power source.
2. During charging, the indicator glows solid red; when charging is complete, the indicator turns off.

Install the TF Card



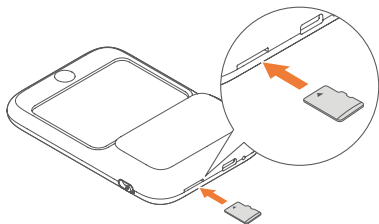

1. This device has a built-in TF card slot and supports up to 128 GB TF cards.

2. Insert the TF card in the direction indicated in the illustration. A click indicates the card is properly seated.



Mode Switching

Slide the mode switch to the corresponding position to switch between four modes:

Mode	Description
 Power On / Off	<ul style="list-style-type: none">• The device automatically powers off after 5 minutes of inactivity in any mode.• After shutdown, slide the switch to the Power On / Off <  > position, then slide it to the desired mode to power on.
 Photo Mode	The camera icon at the upper left indicates that Photo Mode is active.
 Video Mode	The video icon at the upper left indicates that Video Mode is active.
 Metering Mode	The metering icon at the top center, with ISO, aperture, and shutter speed at the bottom, indicates that Metering Mode is active.

Note:

- Switching modes during video recording will stop the recording and save the file automatically.
- The maximum duration for a single video recording is 20 minutes. Recording will automatically stop and the file will be saved when the time limit is reached or the TF card is full.

Operation Guide

Photo Mode

1. Slide the switch to the Photo Mode <  > position.

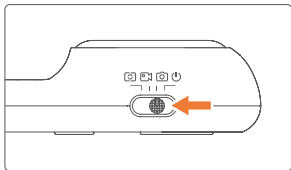

2. Press the <  > or <  > button to switch the aspect ratio.

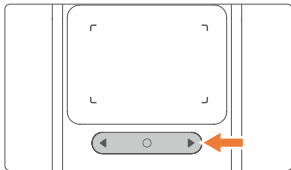

3. Press the shutter button to take a photo.

Video Mode

1. Slide the switch to the Video Mode <  > position.

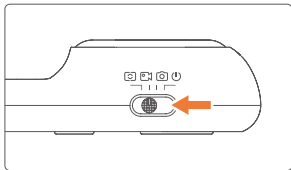

2. Press the <  > or <  > button to switch the aspect ratio.

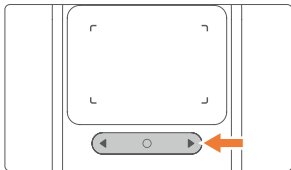

3. Press the shutter button to start or stop recording.

Aspect Ratios

In Photo Mode < [📷] > / Video Mode < [📹] >, press the < ◀ > or < ▶ > button to switch between four composition frames:

16:9	Cinematic Widescreen: Ideal for landscapes and video.
3:2	Standard Film: Classic 35mm format.
4:3	Native Camera: Traditional digital sensor ratio.
1:1	Square: Perfect for social media.

Metering Mode

1. Slide the switch to the Metering Mode < [☀] > position.

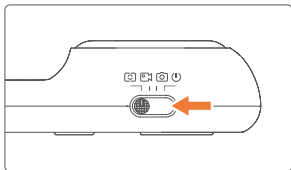

2. Aim at the subject. The device meters approximately 25% of the center area of the transparent viewfinder screen for exposure data.

3. Press the < ○ > button to select the parameter for adjustment; the icon flashes to indicate the adjustable state. If no parameter was previously adjusted, ISO is selected by default.

4. Press the < ◀ > or < ▶ > button to adjust the current parameter value. Press the shutter button to lock and save the metering parameters.

5. Metering Parameter Ranges:

Parameter	Range
ISO	100 - 800
Aperture	f/1.0 - f/64
Shutter Speed	1/8000 - 1s

- Note:**
- ISO can only be adjusted manually.
 - Aperture and shutter speed are linked. When either parameter is adjusted manually, the device automatically calculates and matches the other in real time to maintain the current exposure value (EV).
 - The device automatically exits adjustment mode after 5 seconds of inactivity.

Viewing Data

Connect the device to a phone or computer via the USB-C cable to view photos and videos. If the indicator keeps flashing, check that the TF card is properly inserted and recognized, and ensure the card is formatted to FAT32/exFAT (back up your data before formatting).

Troubleshooting

Problem	Possible Cause	Solution
Device does not power on	<ul style="list-style-type: none">• Battery depleted• System Not Responding	<ul style="list-style-type: none">• Charge using the USB-C cable and try again• Gently press the Reset Hole with a pin to restart
No response when shooting / recording	TF card full	Delete unwanted files or replace the TF card
Abnormal screen display	Firmware exception	Contact official support
Indicator does not light up when charging	USB-C cable not properly connected	Check that both ends of the USB-C cable are fully inserted

Technical Data

Product Name	Godox Transparent Viewfinder Camera
Model	C100
Transparent Viewfinder Transmittance	> 50%
Storage	Built-in TF card slot; supports up to 128 GB
Charging / Data Transfer	USB-C
Charging Input	5V --- 1A
Battery Life	> 1.5 h (continuous shooting)
Operating Temperature	5 - 40°C
Screen Dimensions	60.8 × 47.8mm
Product Dimensions	104.1 × 71.7 × 19.1mm
Net Weight (excluding TF card)	≈ 65g

Specifications and data may be subject to change without notice.

Maintenance

- Power off and disconnect the power supply before cleaning. Use a dry, soft cloth only. Strictly do not use alcohol, benzene, or other volatile solvents.
- To maintain battery health, perform a maintenance charge every 3 months during long-term storage. It is recommended to keep the battery level at 40% - 60%.

产品保修

尊敬的用户,本保修卡是申请保修服务的重要凭证,请您配合销售商填写并妥善保管,谢谢!

产品信息	型号	产品条码
用户信息	姓名	联系电话
	通信地址	
经销商信息	名称	
	联系电话	
	通信地址	
	销售日期	
备注		

注:此表应由销售商盖章确认。

产品信息

本文件适用于相关《产品保修信息》(见后面说明)所列产品,其他非属此范围的产品或部件(如促销品、赠品及其他出厂后附加的部件等)不在此保修承诺内。

保修期

产品及部件的相应保修期按相关的《产品保修信息》执行。保修期自产品首次购买日起算,购买日以购买产品时保修卡登记日期为准。

如何获得保修服务

您可直接与产品销售商或授权服务机构联系,也可拨打神牛产品售后服务电话,与我们联系,由我们的服务人员为您安排服务。申请保修时,您应提供有效的保修卡作为保修凭证,方可获得保修。如您不能提供有效的保修卡,则在我们确认产品或部件属于保修范围的情况下,也可以为您提供保修,但这不作为我们的义务。

不适用保修的情况

如产品存在下列情况,本文件项下的保证和服务将不适用:①产品或部件超过相应保修期;②错误或不当使用、维护或保管导致的故障或损坏,如:不当搬运;非按产品合理预期用途使用;不当插拔外接设备;跌落或外力挤压;接触或暴露于不适当温度、溶剂、酸碱、水浸或潮湿环境;③由非神牛授权机构或人员安装、修理、更改、添加或拆卸造成的故障或损坏;④产品或部件原有识别信息被修改变更或删除;⑤无有效保修卡;⑥使用非合法授权、非标准或非公开发行的软件造成的故障或损坏;⑦因不可抗力或意外事件造成的故障或损坏;⑧其他非因产品本身质量问题导致的故障或损坏。遇上述情况,您应向相关责任方寻求解决,神牛对此不承担任何责任。因非在保修期或保修范围内的部件、附件或软件导致产品不能正常使用的,不是保修范围内的故障。产品使用过程中正常的脱色,磨损和消耗,不是保修范围内的故障。

产品保修和服务支持信息

产品的保修期和服务类型按以下《产品保修信息》执行：

部件	保修期 (月)	保修服务类型
内部电路板	12	客户送修
其他 (例如各类线材或其他包装)	无	客户送修

神牛产品售后服务电话 0755-29609320-8062

Warning

Operating frequency:2402MHz – 2480MHz
Maximum EIRP Power: 5dBm

Declaration of Conformity

GODOX Photo Equipment Co.,Ltd. hereby declares that this equipment is in compliance with the essential requirements and other relevant provisions of Directive 2014/35/EU, 2014/30/EU. They are allowed to be used in all EU member states.

For more information of DoC, Please click this web link:

<https://www.godox.com/eu-declaration-of-conformity/>

FCC Caution

This device complies with part 15 of the FCC Rules. Operation is subject to the following two conditions:

- (1) This device may not cause harmful interference, and
- (2) this device must accept any interference received, including interference that may cause undesired operation.

Any Changes or modifications not expressly approved by the party responsible for compliance could void the user's authority to operate the equipment.

IC Warning

This device complies with Industry Canada licence-exempt RSS standard(s). Operation is subject to the following two conditions:

- (1) This device may not cause interference, and
- (2) This device must accept any interference, including interference that may cause undesired operation of the device.

Le présent appareil est conforme aux CNR d'Industrie Canada applicables aux appareils radio exempts de licence. L'exploitation est autorisée aux deux conditions suivantes:

- (1) l'appareil ne doit pas produire de brouillage, et
- (2) l'utilisateur de l'appareil doit accepter tout brouillage radioélectrique subi, même si le brouillage est susceptible d'en compromettre le fonctionnement.

Warranty

Dear customers, as this warranty card is an important certificate to apply for our maintenance service, please fill in the following form in coordination with the seller and safe-keep it. Thank you!

Product Information	Model	Product Code Number
Customer Information	Name	Contact Number
	Address	
Seller Information	Name	
	Contact Number	
	Address	
	Date of Sale	
Note		

Note: This form shall be sealed by the seller.

Applicable Products

The document applies to the products listed on the Product Maintenance Information (see below for further information). Other products or accessories (e.g. promotional items, giveaways and additional accessories attached, etc.) are not included in this warranty scope.

Warranty Period

The warranty period of products and accessories is implemented according to the relevant Product Maintenance Information. The warranty period is calculated from the day (purchase date) when the product is bought for the first time, and the purchase date is considered as the date registered on the warranty card when buying the product.

How to Get the Maintenance Service

If maintenance service is needed, you can directly contact the product distributor or authorized service institutions. You can also contact the Godox after-sale service call and we will offer you service. When applying for maintenance service, you should provide valid warranty card. If you cannot provide valid warranty card, we may offer you maintenance service once confirmed that the product or accessory is involved in the maintenance scope, but that shall not be considered as our obligation.

Inapplicable Cases

The guarantee and service offered by this document are not applicable in the following cases:

① The product or accessory has expired its warranty period; ② Breakage or damage caused by inappropriate usage, maintenance or preservation, such as improper packing, improper usage, improper plugging in/out external equipment, falling off or squeezing by external force, contacting or exposing to the improper temperature, solvent, acid, base, flooding and damp environments, etc; ③ Breakage or damage caused by non-authorized institution or staff in the process of installation, maintenance, alteration, addition and detachment; ④ The original identifying information of product or accessory is modified, alternated, or removed; ⑤ No valid warranty card; ⑥ Breakage or damage caused by using illegally authorized, nonstandard or non-public released software; ⑦ Breakage or damage caused by force majeure or accident; ⑧ Breakage or damage that could not be attributed to the product itself. Once met these situations above, you should seek solutions from the related responsible parties and Godox assumes no responsibility. The damage caused by parts, accessories and software that beyond the warranty period or scope is not included in our maintenance scope. The normal discoloration, abrasion and consumption are not the breakage within the maintenance scope.

Maintenance and Service Support Information

The warranty period and service types of products are implemented according to the following Product Maintenance Information:

Parts	Maintenance Period (month)	Warranty Service Type
Internal circuit board	12	Customer sends the product to designated site
Other items (cables, package, etc)	NO	Without warranty



Wechat
Official Account
神牛微信公众号

制造商: 深圳市神牛摄影器材有限公司

地址: 深圳市宝安区福海街道塘尾社区耀川工业区厂房 2 栋

电话: +86-755-29609320 (8062) 传真: +86-755-25723423

邮箱: godox@godox.com 网址: godox.com

MANUFACTURER: GODOX Photo Equipment Co., Ltd.

Add.: Building 2, Yaochuan Industrial Zone, Tangwei Community, Fuhai Street,
Bao'an District, Shenzhen 518103, China Tel: +86-755-29609320 (8062)

Fax: +86-755-25723423 E-mail: godox@godox.com Website: godox.com



Copyright © 2026 Godox All Rights Reserved.

中国制造 Made in China