



Wechat
Official Account
神牛微信公众号

深圳市神牛摄影器材有限公司

地址：深圳市宝安区福海街道塘尾社区耀川工业园厂房 2 栋

电话：0755-29609320 (8062) 传真：0755-25723423 邮箱：godox@godox.com

GODOX Photo Equipment Co., Ltd.

Add.: Building 2, Yaochuan Industrial Zone, Tangwei Community, Fuhai Street, Bao'an District, Shenzhen

518103, China Tel: +86-755-29609320(8062) Fax: +86-755-25723423 E-mail: godox@godox.com

www.godox.com

Made in China | 705-BP19K0-00



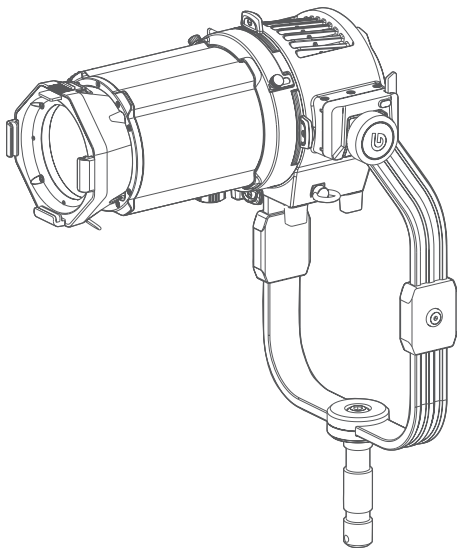

BP19K BP26K BP36K

平头保荣口投影筒
Flat-head Bowens Mount Projection

使用手册
Instruction Manual

V1.0

重要的安全说明及注意事项

首先作为最基本原则：本产品为专业灯光布景设备，应由专业灯光师使用或在专业人士指导下使用。使用时必须始终遵循基本的安全预防措施，具体安全预防措施如下：

1. 使用前必须阅读并理解产品说明书。
2. 专业设备，禁止儿童使用。当儿童靠近时，家长或陪护人必须密切监督，以免儿童因碰撞灯具或私用灯具造成人身伤害。
3. 请勿使用损坏的设备或设备配件，待专业维修人员检查维修，确认设备正常方可使用。
4. 在使用过程中，如果本产品由于跌落、受到挤压或遭受强烈冲击而造成外壳破裂的，请勿继续使用。
5. 请勿私自拆卸产品，如产品出现故障，须由本公司或授权的维修人员进行检查维修。
6. 请勿将设备放置在酒精、汽油等易燃易挥发的溶剂附近。
7. 本厂不推荐的产品附件，请勿使用，以免导致火灾、触电或人身伤害。
8. 安全说明依据本厂严格测试制定，设备设计和规格如有变更，恕不另行通知。客户可以上神牛官网查看最新的电子版说明，了解产品最新资讯。
9. 一年保修期，消耗品配件不在保修范围内。
10. 经发现，擅自检修设备，将取消一年保修期，维修需要收取相关费用。
11. 对于不规范操作引起的机器故障不在保修范围内。

前言

感谢您购买神牛产品！

神牛全新推出平头保荣口投影筒 BP19K、BP26K、BP36K，其操作便捷，含卡槽设计可装入投影片夹，光效设定上更自由；它可以是聚光灯，追光灯，亦或是投影灯；能够为您提供聚光、追光、光束切割、光学变焦、光束投影、光束造型等特色光效。

适用机型

本产品适用于神牛平头保荣口的影视灯，如：M600R、M600Bi Pro、M1000R 等。

部件名称

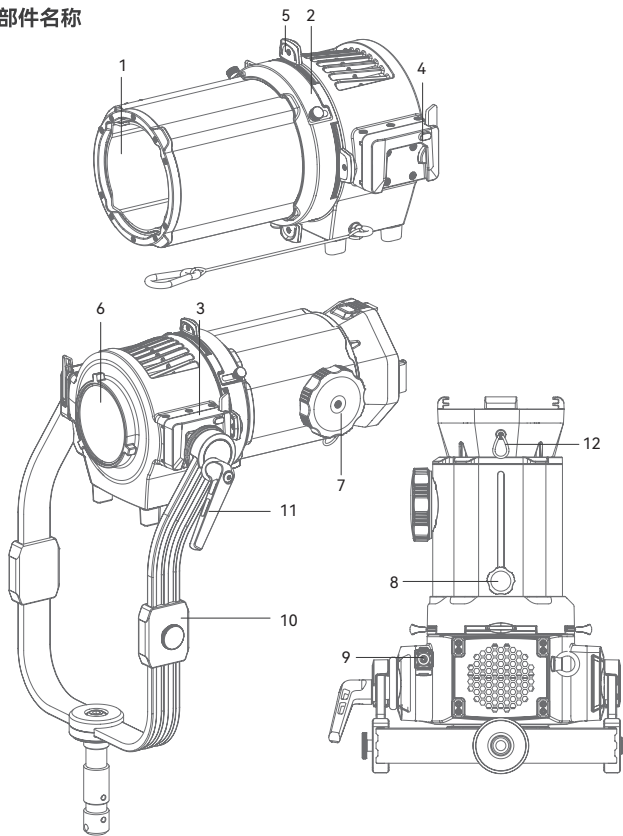

- 1. 镜头安装口
- 2. 投影片夹槽
- 3. 快装装置①

- 4. 快装装置②
- 5. 内置切光片
- 6. 平头保荣口

- 7. 镜头调焦旋钮
- 8. 镜头固定旋钮
- 9. 信号线接口

- 10. U 架组件
- 11. 方向调节把手
- 12. 安全扣

BP19K 物品清单

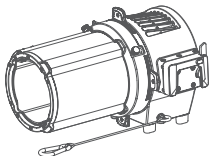

投影筒 × 1

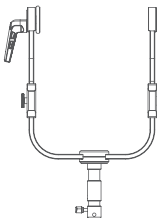

U 架组件 × 1

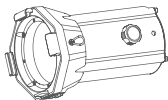

19°光学投影镜头 × 1
(BP-Lens19)



投影片组 × 1

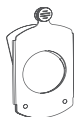

投影片夹 × 1
(VSA-CF)

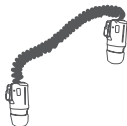

信号线 × 1



箱包 × 1



说明书 × 1

BP26K 物品清单

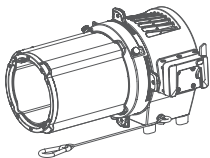

投影筒 × 1

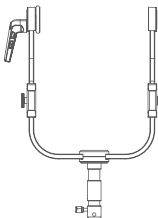

U 架组件 × 1

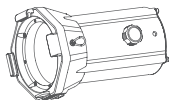

26°光学投影镜头 × 1
(BP-Lens26)



投影片组 × 1

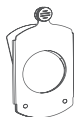

投影片夹 × 1
(VSA-CF)

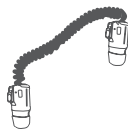

信号线 × 1



箱包 × 1



说明书 × 1

BP36K 物品清单

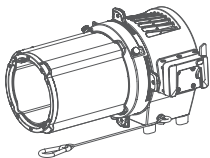

投影筒 × 1

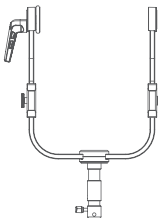

U 架组件 × 1

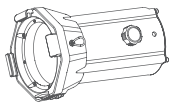

36°光学投影镜头 × 1
(BP-Lens36)



投影片组 × 1

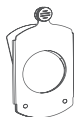

投影片夹 × 1
(VSA-CF)

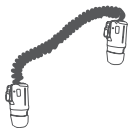

信号线 × 1



箱包 × 1



说明书 × 1

安装投影片夹

逆时针拧松投影筒的两个螺丝栓（只需要拧松，不需要拧下），滑开槽盖，将装好投影片的投影片夹插入槽中即可。

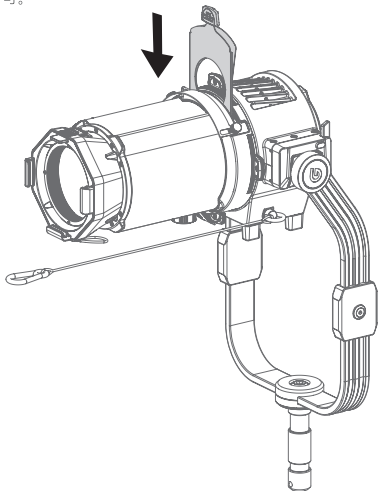

镜头装卸

安装：将镜头带螺丝孔位置顺着投影筒上的镜头固定旋钮这一头插入，接着顺时针拧紧固定旋钮，再将投影筒上的安全绳扣在镜头的安全扣上。

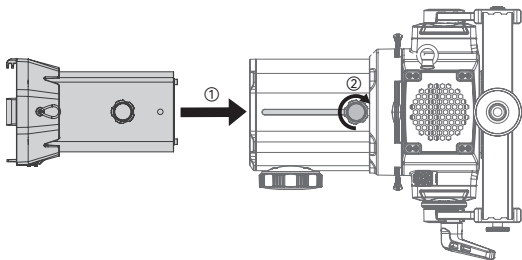

拆卸：解开安全绳后，逆时针拧松固定旋钮，可将镜头取出。

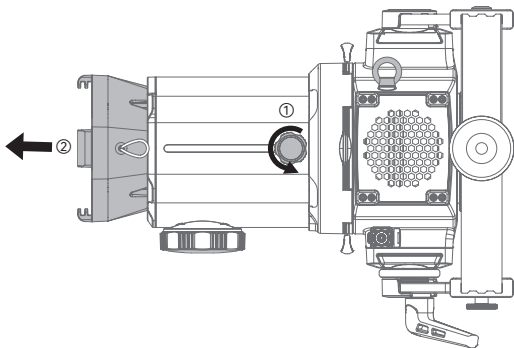

投影筒装卸（以 M1000R 灯具为例）

安装：将投影筒的平头保荣口对准 M1000R 插入，接着顺时针旋转投影筒，M1000R 卡口推制将自动锁紧，即安装完成。

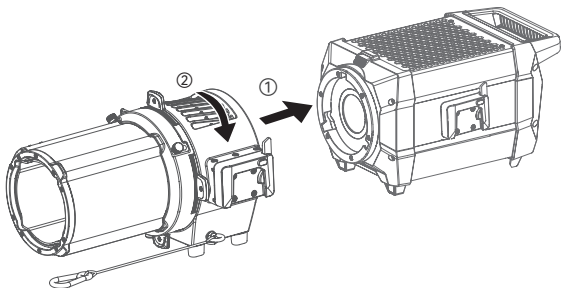

拆卸: 按住 M1000R 卡口推制的同时逆时针旋转投影筒, 可将投影筒卸下。

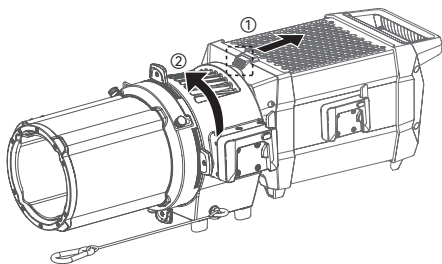

U 架装卸

安装: 将投影筒放于平面, 按住快装装置按钮的同时拨开扳手, 两侧都打开; 双手握住 U 架两端, 对准快装装置插入, 接着将两边扳手回拨锁紧。

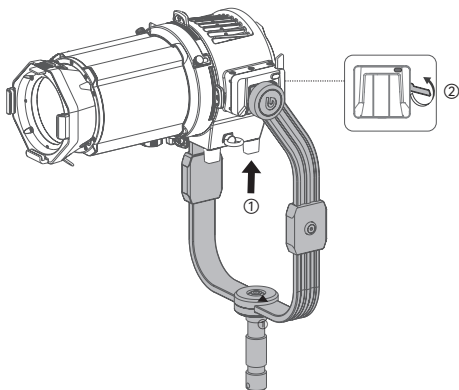

拆卸: 将投影筒放于平面, 按住快装装置按钮的同时拨开扳手, 两侧都打开后将 U 架取出。

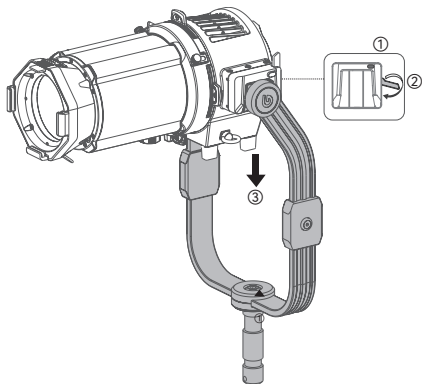

镜头调焦旋钮

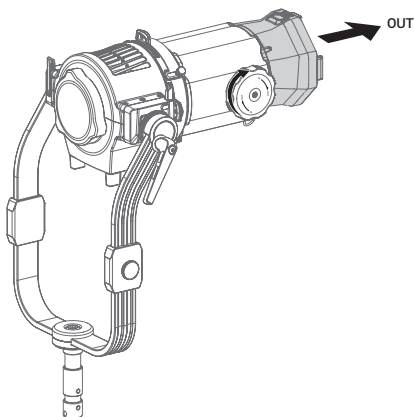

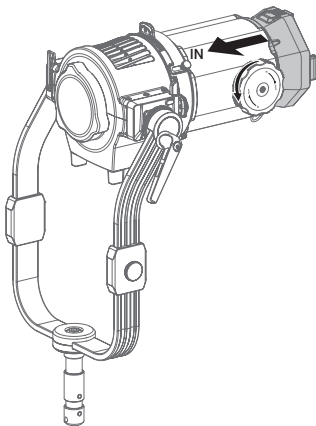

信号线接口（以 M1000R 灯具为例）

使用标配信号线，连接 M1000R 灯体上的 ACC 接口，可开启投影筒风扇功能。

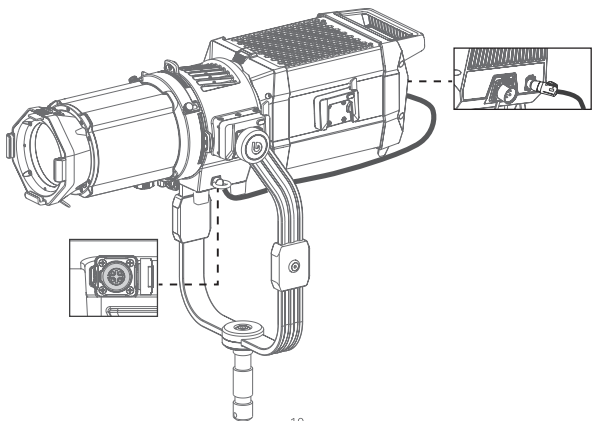

照度数据

投影筒搭配不同镜头 (灯具为 M1000R)

色温	测试条件	照度单位	3m	5m	7m
1800K	M1000R 裸灯	lux	1850	781	426
		fc	172	73	40
	搭配 19°镜头	lux	4960	1670	847
		fc	461	155	79
	搭配 26°镜头	lux	3430	1280	615
		fc	319	119	57
	搭配 36°镜头	lux	2880	1000	501
		fc	267	93	47
2800K	M1000R 裸灯	lux	4280	1720	976
		fc	398	160	91
	搭配 19°镜头	lux	12200	3940	1950
		fc	1130	366	181
	搭配 26°镜头	lux	6480	2380	1410
		fc	602	221	131
	搭配 36°镜头	lux	6840	2330	1180
		fc	636	217	109
3200K	M1000R 裸灯	lux	4220	1740	962
		fc	392	162	89
	搭配 19°镜头	lux	11800	3920	1950
		fc	1100	364	181
	搭配 26°镜头	lux	8220	2820	1400
		fc	764	262	130
	搭配 36°镜头	lux	6800	2340	1180
		fc	631	217	109
4300K	M1000R 裸灯	lux	4120	1730	935
		fc	382	160	87
	搭配 19°镜头	lux	11800	3840	1920
		fc	1090	356	178
	搭配 26°镜头	lux	8050	2760	1370
		fc	748	257	127
	搭配 36°镜头	lux	6670	2290	1150
		fc	620	213	107
5600K	M1000R 裸灯	lux	4010	1650	923
		fc	373	153	86
	搭配 19°镜头	lux	11600	3740	1860
		fc	1080	348	173
	搭配 26°镜头	lux	7980	2670	1330
		fc	741	248	124
	搭配 36°镜头	lux	6500	2230	1120
		fc	604	207	104
6500K	M1000R 裸灯	lux	3910	1590	891
		fc	363	148	83
	搭配 19°镜头	lux	11200	3610	1800
		fc	1040	335	167
	搭配 26°镜头	lux	7610	2590	1280
		fc	707	241	119
	搭配 36°镜头	lux	6280	2150	1090
		fc	584	200	101

色温	测试条件	照度单位	3m	5m	7m
8500K	M1000R 裸灯	lux	3700	1500	848
		fc	344	140	79
	搭配 19°镜头	lux	10600	3580	1790
		fc	986	333	166
	搭配 26°镜头	lux	7280	2550	1250
		fc	677	237	117
	搭配 36°镜头	lux	5940	2030	1030
		fc	552	189	96
10000K	M1000R 裸灯	lux	3570	1450	823
		fc	332	135	76
	搭配 19°镜头	lux	10300	3300	1640
		fc	955	306	152
	搭配 26°镜头	lux	6900	2370	1180
		fc	641	221	110
	搭配 36°镜头	lux	5750	1970	1000
		fc	534	183	93
R(红光)	M1000R 裸灯	lux	859	390	208
		fc	80	36	19
	搭配 19°镜头	lux	2550	830	400
		fc	237	77	37
	搭配 26°镜头	lux	1700	552	287
		fc	158	51	27
	搭配 36°镜头	lux	1430	450	238
		fc	133	42	22
G(绿光)	M1000R 裸灯	lux	1490	625	345
		fc	138	58	32
	搭配 19°镜头	lux	4380	1380	687
		fc	407	128	64
	搭配 26°镜头	lux	2930	995	501
		fc	272	93	47
	搭配 36°镜头	lux	2440	825	422
		fc	226	77	39
B(蓝光)	M1000R 裸灯	lux	524	212	121
		fc	49	20	11
	搭配 19°镜头	lux	1550	495	249
		fc	144	46	23
	搭配 26°镜头	lux	1050	356	180
		fc	98	33	17
	搭配 36°镜头	lux	859	294	152
		fc	80	27	14

以上测试皆在灯体 100%亮度且投影筒设为聚光状态下进行。

规格参数

	投影筒	19°光学投影镜头	26°光学投影镜头	36°光学投影镜头
尺寸≈	303*227*207mm	135*219*137mm		
重量≈	5.4kg	1.9kg	1.7kg	2kg

设计和规格如有变更，恕不另行通知。

Safety Instructions and Attentions

First of all, as the most basic principle: This product is a professional lighting set equipment and should be used by professional lighting engineers or under the guidance of professionals. Basic safety attentions must always be followed during use, as follows:

1. Before use, please read and understand these instructions and attentions.
2. Professional lighting is prohibited for children. When children are near, parents or accompanying persons must supervise closely to prevent children from personal injury due to collision with lamps or private use of lamps.
3. Do not use damaged equipment or accessories, and wait for professional maintenance personnel to check and repair to confirm being normal before use.
4. During using, if the casing of this product is broken due to being dropped, squeezed or subjected to strong impact, please do not use it, so as to avoid electric shock injury due to contact with internal electronic components.
5. Do not disassemble the product without permission. If the product fails, it must be checked and repaired by authorized maintenance personnel.
6. Do not place equipment near flammable and volatile solvents such as alcohol and gasoline.
7. Do not use accessories that are not recommended by our factory to avoid fire, electric shock or personal injury.
8. The safety instructions are formulated according to the strict testing of the factory, and the design and specifications of the equipment are subject to change without prior notice. For latest product information, please check the GODOX website and view latest electronic instruction.
9. One-year warranty period, accessories such as consumable batteries, adapters, power cords, etc. are not covered by this warranty.
10. If it is found that the equipment is repaired without authorization, the one-year warranty period will be cancelled and relevant fees will be charged for maintenance.
11. Machine failures caused by non-standard operation are not covered by the warranty.

Foreword

Thank you for purchasing !

Flat-head Bowens mount projection BP19K, BP26K and BP36K are conveniently operational with slots to insert gobo sets, able to create light effects such as spotlight, chasing, beam cutting, optical zoom, beam projection, beam modelling and etc.

Compatible Product Models

This product is compatible with Godox flat-head Bowens mount LED lights such as M600R, M600Bi Pro and M1000R.

Name of Parts

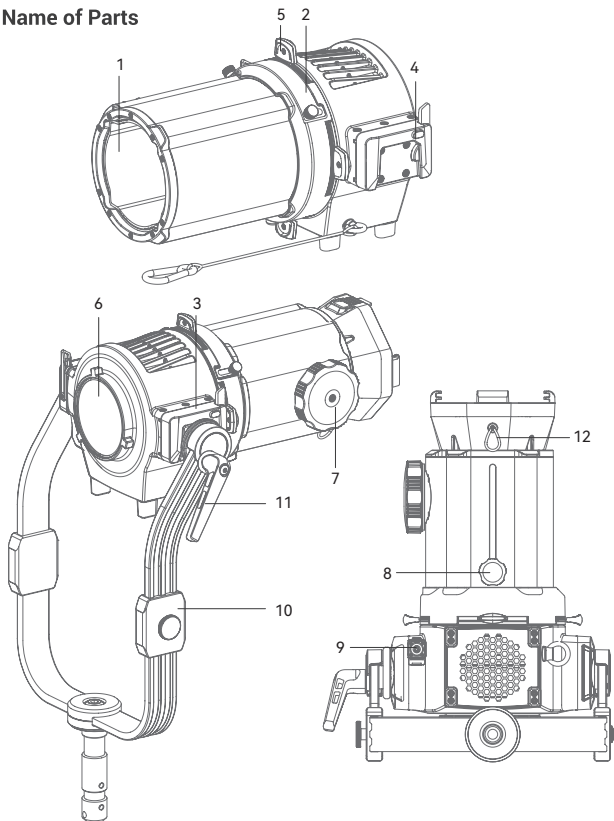

1. Lens Attach Port

2. Gobo Holder Slot

3. Quick Install Device ①

4. Quick Install Device ②

5. Shutter Blade

6. Flat-head Bowens Mount

7. Lens Zoom Dial

8. Lens Fixing Dial

9. Signal Wire Port

10. U-type Bracket Set

11. Direction Adjusting Handle

12. Safety Buckle

What's Inside BP19K

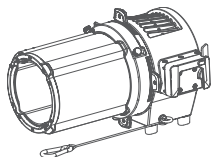

Projection × 1

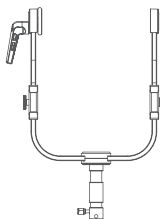

U-type Bracket Set × 1

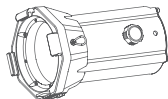

Projection Lens 19° × 1
(BP-Lens19)



Gobo Set × 1

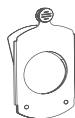

Gobo Holder × 1
(VSA-CF)

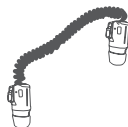

Signal Wire × 1



Storage Bag × 1



Instruction Manual × 1

What's Inside BP26K

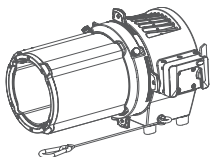

Projection × 1

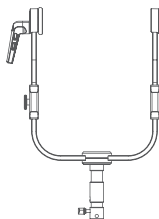

U-type Bracket Set × 1

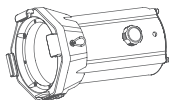

Projection Lens 26° × 1
(BP-Lens26)



Gobo Set × 1



Gobo Holder × 1
(VSA-CF)

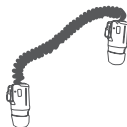

Signal Wire × 1



Storage Bag × 1



Instruction Manual × 1

What's Inside BP36K

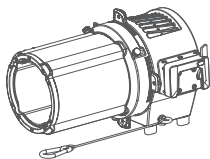

Projection × 1

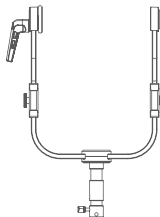

U-type Bracket Set × 1

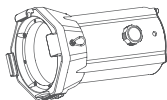

Projection Lens 36° × 1
(BP-Lens36)



Gobo Set × 1

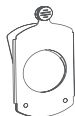

Gobo Holder × 1
(VSA-CF)

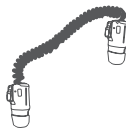

Signal Wire × 1



Storage Bag × 1



Instruction Manual × 1

Installing the Gobo Holder

Loosen the two screws on the projection counterclockwise (only need to be loosened, no need to take them off), slide open the slot cover, then insert the gobo holder with gobo set into the slot.

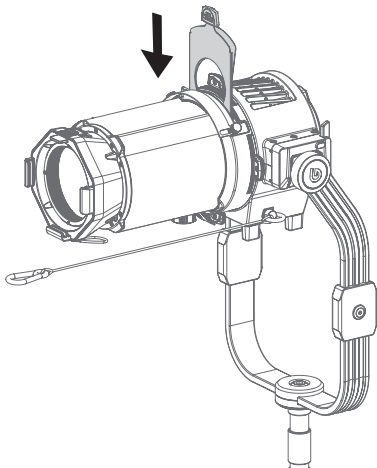

Installing and Disassembling the Lens

Install: Align the screw hole side of the lens with the lens fixing dial side of the projection and insert in, and rotate the lens fixing dial clockwise to install, then attach the safety rope on the projection to the safety buckle on the lens.

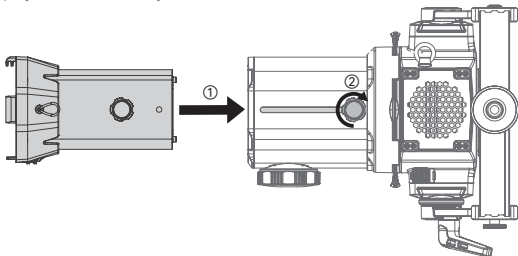

Disassemble: Untie the safety rope, then rotate the lens fixing dial anticlockwise to disassemble the lens.

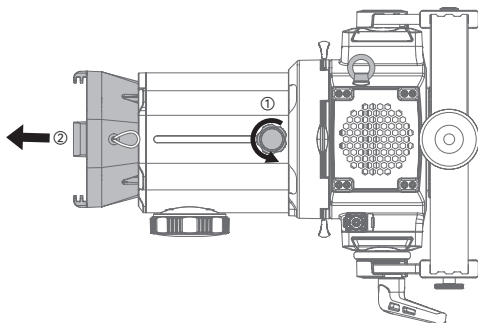

Installing and Disassembling the Projection (take M1000R as an example)

Install: Align the flat-head Bowens mount on the projection with the mount on M1000R and insert in, then rotates the projection clockwise, the mount locking pusher on M1000R will automatically be locked.

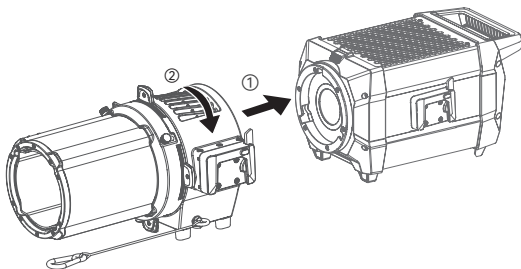

Disassemble: Press the mount locking pusher on M1000R, then then rotates the projection anticlockwise to disassemble it.

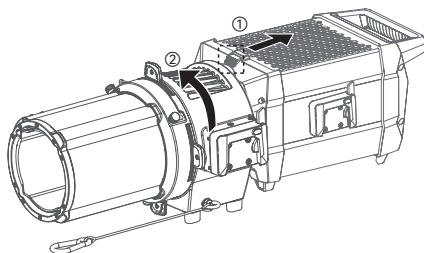

Installing and Disassembling the U-type Bracket

Install: Place the projection on a flat surface, press down the quick install device button and remove the wrench. Align both ends of the U-type bracket with the quick install device and insert in, lock the wrenches on both sides.

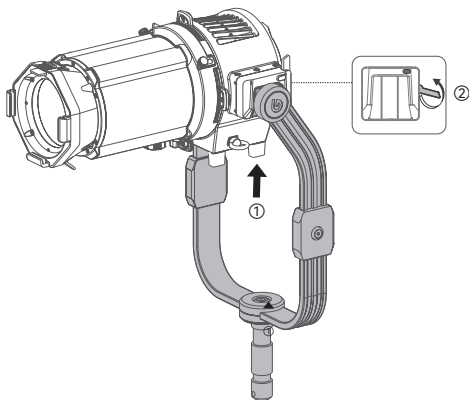

Disassemble: Place the projection on a flat surface, press and hold the quick install device button and release the wrench to remove the U-type bracket.

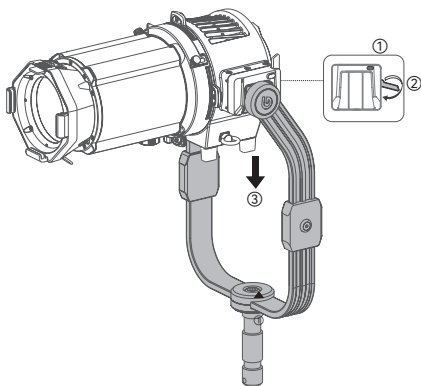

Lens Zoom Dial

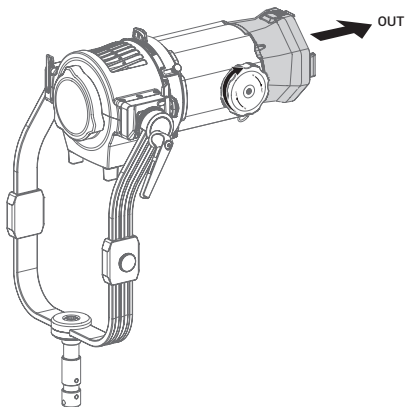

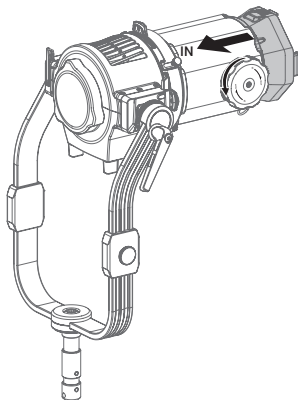

Signal Wire Port (take M1000R as an example)

Connect the projection to the ACC port on M1000R with the attached signal wire, the fan and accessory recognition functions are available.

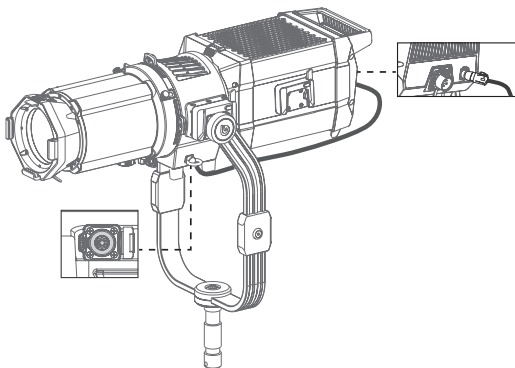

Illuminance Data

Projection with Different Lens (take M1000R as an example)

CCT	Testing Condition	Unit	3m	5m	7m
1800K	M1000R Bare Light	lux	1850	781	426
		fc	172	73	40
	With 19° Lens	lux	4960	1670	847
		fc	461	155	79
	With 26° Lens	lux	3430	1280	615
		fc	319	119	57
2800K	M1000R Bare Light	lux	2880	1000	501
		fc	267	93	47
	With 19° Lens	lux	4280	1720	976
		fc	398	160	91
	With 26° Lens	lux	12200	3940	1950
		fc	1130	366	181
3200K	M1000R Bare Light	lux	6480	2380	1410
		fc	602	221	131
	With 19° Lens	lux	6840	2330	1180
		fc	636	217	109
	With 26° Lens	lux	8220	2820	1400
		fc	764	262	130
4300K	M1000R Bare Light	lux	6800	2340	1180
		fc	631	217	109
	With 19° Lens	lux	4120	1730	935
		fc	382	160	87
	With 26° Lens	lux	11800	3840	1920
		fc	1090	356	178
5600K	M1000R Bare Light	lux	8050	2760	1370
		fc	748	257	127
	With 19° Lens	lux	6670	2290	1150
		fc	620	213	107
	With 26° Lens	lux	4010	1650	923
		fc	373	153	86
6500K	M1000R Bare Light	lux	11600	3740	1860
		fc	1080	348	173
	With 19° Lens	lux	7980	2670	1330
		fc	741	248	124
	With 26° Lens	lux	6500	2230	1120
		fc	604	207	104
6500K	M1000R Bare Light	lux	3910	1590	891
		fc	363	148	83
	With 19° Lens	lux	11200	3610	1800
		fc	1040	335	167
	With 26° Lens	lux	7610	2590	1280
		fc	707	241	119
6500K	With 36° Lens	lux	6280	2150	1090
		fc	584	200	101

CCT	Testing Condition	Unit	3m	5m	7m
8500K	M1000R Bare Light	lux	3700	1500	848
		fc	344	140	79
	With 19° Lens	lux	10600	3580	1790
		fc	986	333	166
	With 26° Lens	lux	7280	2550	1250
		fc	677	237	117
	With 36° Lens	lux	5940	2030	1030
		fc	552	189	96
10000K	M1000R Bare Light	lux	3570	1450	823
		fc	332	135	76
	With 19° Lens	lux	10300	3300	1640
		fc	955	306	152
	With 26° Lens	lux	6900	2370	1180
		fc	641	221	110
	With 36° Lens	lux	5750	1970	1000
		fc	534	183	93
R (Red)	M1000R Bare Light	lux	859	390	208
		fc	80	36	19
	With 19° Lens	lux	2550	830	400
		fc	237	77	37
	With 26° Lens	lux	1700	552	287
		fc	158	51	27
	With 36° Lens	lux	1430	450	238
		fc	133	42	22
G (Green)	M1000R Bare Light	lux	1490	625	345
		fc	138	58	32
	With 19° Lens	lux	4380	1380	687
		fc	407	128	64
	With 26° Lens	lux	2930	995	501
		fc	272	93	47
	With 36° Lens	lux	2440	825	422
		fc	226	77	39
B (Blue)	M1000R Bare Light	lux	524	212	121
		fc	49	20	11
	With 19° Lens	lux	1550	495	249
		fc	144	46	23
	With 26° Lens	lux	1050	356	180
		fc	98	33	17
	With 36° Lens	lux	859	294	152
		fc	80	27	14

Note: All the above tests are based on the condition of 100% brightness in spotting status.

Technical Data

	Projection	Projection Lens 19°	Projection Lens 26°	Projection Lens 36°
Dimension≈	11.93"*8.94"*8.15"	5.31"*8.62"*5.39"		
Net Weight≈	5.4kg	1.9kg	1.7kg	2kg

Specifications and data may subject to changes without notice.

产品保修

尊敬的用户，本保修卡是申请保修服务的重要凭证，请您配合销售商填写并妥善保管，谢谢！

产品信息	型号	产品条码
用户信息	姓名	联系电话
	通信地址	
销售商信息	名称	
	联系电话	
	通信地址	
	销售日期	
备注		

注：此表应由销售商盖章确认。

产品信息

本文件适用于相关《产品保修信息》(见后面说明)所列产品,其他非属此范围的产品或部件(如促销品、赠品及其他出厂后附加的部件等)不在此保修承诺内。

保修期

产品及部件的相应保修期按相关的《产品保修信息》执行。保修期自产品首次购买日起算，购买日以购买产品时保修卡登记日期为准。

如何获得保修服务

您可直接与产品销售商或授权服务机构联系，也可拨打神牛产品售后服务电话，与我们联系，由我们的服务人员为您安排服务。申请保修时，您应提供有效的保修卡作为保修凭证，方可获得保修。如您不能提供有效的保修卡，则在我们确认产品或部件属于保修范围的情况下，也可以为您提供保修，但这不作为我们的义务。

不适用保修情况

如产品存在下列情况, 本文件项下的保证和服务将不适用: ①产品或部件超过相应保修期; ②错误或不当使用、维护或保管导致的故障或损坏, 如: 不当搬运; 非按产品合理预期用途使用; 不当插拔外接设备; 跌落或外力挤压; 接触或暴露于不当温度、溶剂、酸碱、水浸或潮湿环境; ③由非神牛授权机构或人员安装、修理、更改、添加或拆卸造成的故障或损坏; ④产品或部件原有识别信息被修改变更或删除; ⑤无有效保修卡; ⑥使用非法授权、非标准或非公开发行的软件造成的故障或损坏; ⑦因不可抗力或意外事件造成的故障或损坏; ⑧其他非因产品本身质量问题导致的故障或损坏。遇上述情况, 您应向相关责任方寻求解决, 神牛对此不承担任何责任。因非在保修期或保修范围内的部件、附件或软件导致产品不能正常使用的, 不是保修范围内的故障。产品使用过程中正常的脱色, 磨损和消耗, 不是保修范围内的故障。

产品保修和服务支持信息

产品的保修期和服务类型按以下《产品保修信息》执行:

产品类别	选件名称	保修期(月)	保修服务类型
部件	内部元器件	12	客户送修
其他	如外壳、保护罩、锁紧装置、包装等。	无	无保修

神牛产品售后服务电话 0755-29609320-8062

Warranty

Dear customers, as this warranty card is an important certificate to apply for our maintenance service, please fill in the following form in coordination with the seller and safe-keep it. Thank you!

Product Information	Model	Product Code Number
Customer Information	Name	Contact Number
	Address	
Seller Information	Name	
	Contact Number	
	Address	
	Date of Sale	
Note		

Note: This form shall be sealed by the seller.

Applicable Products

Applicable ProductsThe document applies to the products listed on the Product Maintenance Information (see below for further information). Other products or accessories (e.g. promotional items,giveaways and additional accessories attached,etc.) are not included in this warranty scope.

Warranty Period

The warranty period of products and accessories isimplemented according to the relevant Product Maintenance Information. The warranty period is calculated from the day(purchase date) when the product is bought for the first time,And the purchase date is considered as the date registered onthe warranty card when buying the product.

How to Get the Maintenance Service

If maintenance service is needed, you can directly contact the product distributor or authorized service institutions. You can also contact the Godox after-sale service call and we will offer you service. When applying for maintenance service, you should provide valid warranty card. If you cannot provide valid warranty card, we may offer you maintenance service once confirmed that the product or accessory is involved in the maintenance scope, but that shall not be considered as our obligation.

Inapplicable Cases

The guarantee and service offered by this document are not applicable in the following cases: ① The product or accessory has expired its warranty period; ② Breakage or damage caused by inappropriate usage, maintenance or preservation, such as improper packing, improper usage, improper plugging in/out external equipment, falling off or squeezing by external force, contacting or exposing to the improper temperature, solvent, acid, base, flooding and damp environments, etc; ③ Breakage or damage caused by non-authorized institution or staff in the process of installation, maintenance, alternation, addition and detachment; ④ The original identifying information of product or accessory is modified, alternated, or removed; ⑤ No valid warranty card; ⑥ Breakage or damage caused by using illegally authorized, nonstandard or non-public released software; ⑦ Breakage or damage caused by force majeure or accident; ⑧ Breakage or damage that could not be attributed to the product itself. Once met these situations above, you should seek solutions from the related responsible parties and Godox assumes no responsibility. The damage caused by parts, accessories and software that beyond the warranty period or scope is not included in our maintenance scope. The normal discoloration, abrasion and consumption are not the breakage within the maintenance scope.

Maintenance and Service Support Information

The warranty period and service types of products are implemented according to the following Product Maintenance Information:

Product Type	Name	Maintenance Period(month)	Warranty Service Type
Parts	Internal electrical parts	12	Customer sends the product to designated site
Other Items	Lamp body, lamp cover, locking device, package, etc.	No	Without warranty

Godox After-sale Service Call +86-755-29609320(8062)